

Description

DIN Rail Support Brackets

Construction

Steel, Galvanic Zinc Plating and Passivation

Agency Approvals • ROHS

SSB DIN Rail Support Brackets Ordering Code

Part #	Dimensions X in. (mm)
SSB20-M6	.787 (20.00)
SSB25-M6	.984 (25.00)
SSB30-M6	1.181 (30.00)
SSB40-M6	1.575 (40.00)
SSB50-M6	1.969 (50.00)
SSB70-M6	2.756 (70.00)
SSB90-M6	3.543 (90.00)

ASB DIN Rail Support Brackets Ordering Code

Part #	Dimensions X in. (mm)
ASB49-M6	1.929 (49.00)
ASB58-M6	2.283 (58.00)
ASB68-M6	2.677 (68.00)
ASB78-M6	3.071 (78.00)
ASB88-M6	3.465 (88.00)
ASB98-M6	3.858 (98.00)

SSB

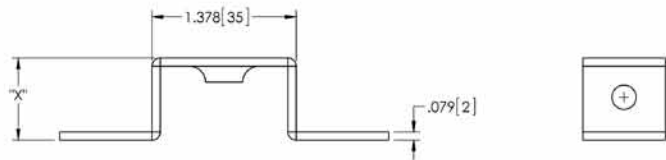
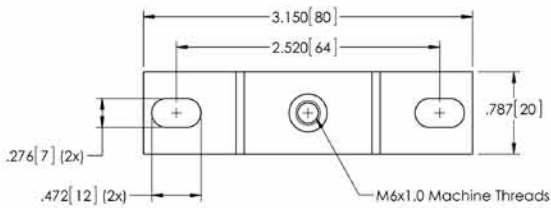

ASB

NOTES

1. STEEL MOUNTING RAIL BRACKET.
2. GALVANIC ZINC PLATING AND PASSIVATION.

